



MINNESOTA BUILDERS EXCHANGE

# Weekly Bulletin

Issue No. 12 • Wednesday, March 20, 2024 • [www.mbex.org](http://www.mbex.org)

## Five Things To Know & Do This Week:

1.) This Thursday (3/21) - our next [Online Plan Room demo!](#) Join us at 9:00am, whether you've only recently joined, want a refresher, or are curious about membership and want a sneak peek at our online platform.

2.) In the market for a large format printer? MBEX is selling two: an [OCE 350](#) black and white plotter, scanner, and printer; and a [Canon IPF 765 Color](#) plotter printer. Both are in excellent condition, having been regularly maintained. If interested in purchasing, please contact Don O'Connor for more information: [don@mbex.org](mailto:don@mbex.org) | [\(218\) 722-2836](tel:2187222836)

3.) Just in time for spring construction season. New [tech tools](#) include heavy equipment innovations, a handheld radar scanner and digital twin upgrades.

4.) Calling all women in construction and their allies! We recently [announced](#) the MBEX Women's POWER series for 2024, and we want to see you on April 2nd for the first workshop, [Making It In a Male-Dominated World](#), led by Nicole Middendorf.

### 5.) Test Your Knowledge:

The developers behind what would be the tallest building in the U.S. say they've secured full funding for the planned 1,907-foot-tall Legends Tower (making it the fifth tallest building in the world). Where is this building going up?

- A.) Des Moines, Iowa
- B.) Oklahoma City, Oklahoma
- C.) Salt Lake City, Utah
- D.) Charlotte, North Carolina

[See the Answer](#)

*Always bring a saw to a job interview so you can cut to the chase.*

### IN BRIEF:

- **Register Now:** Join us April 17th for the annual MBEX Spring Social
- **Legislature:** Updates on current bills being considered in the 2024 session
- **Tips & Tricks:** Creating a SAM Search for a project filter
- **Input Prices:** Recent surges indicate a bumpy road ahead for the industry
- **ASHRAE Code now requires on-site renewables, the DMI recedes in February & the latest data regarding women working in construction:** Five construction headlines, and Meta's \$800M data center in Rosemount
- **Member Benefit:** Fresh savings await through National Purchasing Partners (NPP)



## REGISTER NOW: MBEX Spring Social

An annual social, this event provides MBEX members the opportunity to mingle, network, and deepen their connections with other industry professionals.

- **DATE:** Wednesday, April 17
- **TIME:** 3:00pm - Doors open, drinks & networking | 5:00pm - Program, raffle winners & door prizes
- **LOCATION:** [TPC Twin Cities](#) (Blaine, Minn.)
- **PRICING:** \$40 per person - *Early Bird special through 4/5*

Join MBEX for an afternoon with fellow local construction business owners, executives, and industry professionals, and gain several chances to win exciting door prizes or indulgent bottles of wine or spirits.

### Guest Speaker

Our special guest speaker at this year's event is [Timothy O'Neill](#), Department of Employment and Economic Development's (DEED) regional analyst for the seven-county Twin Cities region of Minnesota.

### Wine & Spirits Pull

Back by popular demand at this year's Spring Social is our Wine & Spirits Pull! Attendees can purchase a mysteriously-wrapped package that contains either a bottle of wine or spirits potentially of much greater value than the purchase price. All funds from the Pull go directly to support the [MBEX / TBG Construction Scholarship](#).

### Raffles & Door Prizes

We will also have our traditional 50/50 cash raffle where the winner takes home half of the winnings and the other half directly supports the MBEX Scholarship Fund.

Sponsorships are also available at Platinum, Gold, Silver, and Bronze levels. Opportunities to sponsor the Wine & Spirits Pull as well as door prizes are also available.

*Bring a non-member as your guest to the event, and that prospective member can attend the event for free. [Email Ashlee](#) to confirm your +1.*

[Register to Attend MBEX's Spring Social](#)

---



## Legislature 2024 Updates

### Transportation Projects

In local government transportation news, the St. Paul City Council passed \$45.1-million for street, parks and recreation centers funded by the City's new 1% sales tax. St. Paul Parks & Recreation's projects includes a total of \$31.4-million intended to address long-deferred maintenance of park buildings, athletics fields, and downtown parks, as well as design work for planned citywide assets including the East Side Community Center and the River Balcony. \$13.7-million will leverage 1% sales tax funding to support the Department of Public Works improvements of Grand Avenue. A full list of funded projects is [available online](#).

### Red-Light Laws

The House Transportation heard and passed a bill that would allow local and state governments to enforce speed limits and [red-light laws](#) with cameras in work zones and within 2,000-feet of a school. This bill has been referred to the Judiciary and Civil Law Committee for consideration.

### Multi-Part Independent Contractor Testing

A significant piece of legislation was recently introduced that establishes a [new multi-part independent contractor test](#) for building construction and improvement services. The new multi-part test increases the current nine-factor test to 14 requirements to identify and classify as an independent contractor operating in construction and improvement services. The legislation also provides for additional penalties and enforcement of misclassification of employees and construction employees, including individual and successor liability. The proposal is expected to be heard in various committees in the coming weeks.

### Underground Utility Locating Bill

The Worker Safety and Underground Utility Locating bill provides greater accuracy of future utility installation locations and repairs, better tracking of complaints and accountability measures, and improved timing of locate requests and more active participation of facility owners in preconstruction meetings. A hearing for this bill was held on March 19, 2024. [House File 2717](#) | [Senate File 2723](#)

### REMINDER: Spring Load Restrictions

The Minnesota Department of Transportation (MnDOT) ended spring load restrictions in the North frost zone Monday, March 18. Seasonal load limit zones and restricted routes can be found on the [MnDOT load limits map](#). Start and end dates and other load limit information can be found [here](#).

*These legislative updates were provided by Associated General Contractors - Minnesota (AGC - MN), and we thank them for their coverage of these House and Senate proceedings.*

# TIPS & TRICKS

## NAVIGATING THE ONLINE PLAN ROOM



### TIPS & TRICKS: Creating a SAM Search Filter

Searching the index of a spec book to see if your trade is listed is one thing, but what if you're looking for a very specific, hard-to-find word or phrase that are not listed in the spec book?

SAM Search is an excellent way to narrow a search to specific keywords or phrases members want to find in a project's specifications. A SAM Search saves time that may be spent needlessly scanning section after section of specs. It also helps find sections which may have otherwise been missed.

#### First: *what is SAM Search?*

SAM stands for **S**pec and **A**ddenda **M**ining. It allows members to search the entire spec book --- not just the spec index.

Trade names such as "honeywell," "dupont," "prosoco," and "trane" can be located quickly and easily, and even tied to your nightly updates email. Other words that are difficult to find are readily available as well, such as "retaining wall," "valve," "crane," and other specialty types of work that may have been missed in a Spec Index or CSI Master Code search.

#### When conducting a SAM Search:

1.) Enter any word or phrase you would like to search for in the body of every specification. Broad phrases such as "mechanical," "electrical," or "lighting" should be avoided (but they can serve as a great starting point).

SAM Search is designed to find specific, hard-to-find phrases or words. This distinguishes it from the Spec Index Search.

2.) After entering your desired search terms / phrases, finish setting up your filter by selecting the desired project phases, project types, and/or geographical areas. Give your filter a name, then hit 'Save Filter'.

3.) The next screen will show your search results, or keyword / phrase "hits". Every "hit" will show the project and spec section containing a specific keyword or phrase originally entered as a SAM search term.

4.) Clicking on one of the links underneath the search opens the spec section and automatically conducts a search for the keyword, jumping directly to where it is located in the spec book.

5.) If there are multiple hits, there will be multiple links that will send members directly to each individual reference.

Play around with your search terms, especially if you're not finding projects of interest

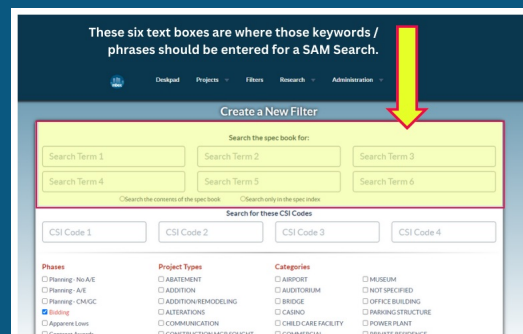

Click above image to enlarge.

for your business. There is no limit to how many search filters can be created, so set up as many as you'd like!

-----

If you have questions regarding the Online Plan Room, get in touch and we'd be happy to assist: [info@mbex.org](mailto:info@mbex.org) or [\(612\) 381-2620](tel:6123812620).



### **Input Price Surge Signals Bumpy Road Ahead**

Construction input prices increased 1.4% in February predominantly due to lingering inflation, according to a new Associated Builders and Contractors' analysis of U.S. Bureau of Labor Statistics Produce Price Index data.

The bad news is twofold for contractors, said Anirban Basu, ABC chief economist. First, higher input prices generally lead to lower demand for construction services. When combined with already pricey project financing costs, project owners are less likely to proceed with construction work due to the high and increasing input costs.

Second, recent inflation data suggest a higher probability of prolonged elevated interest rates. Heightened borrowing costs would slow construction activity, particularly for privately led projects.

*The February increase marks the second straight month of price jumps, suggesting a turbulent landscape for the construction industry.*

[Read More on Construction Dive](#)



A valuable benefit of an MBEX membership is invitations to our social and educational events; by being an employee of a member company, you too can take advantage and attend any and all MBEX-sponsored events.

**\*\* indicates a newly added event**

### **March 20 & 21 - Reading Construction Documents**

Designed to quickly familiarize students with the basics of reading and understanding construction documents, this two-part online program is perfect for apprentices, entry-level tradespersons, project coordinators, assistant project managers, new project managers, estimators, specialty sales representatives, entry-level architectural or engineering designers, or anyone in career transition looking for a refresher. [Register Here](#)

### **March 21 - MBEX Online Plan Room Demo**

From navigating the Deskpads, setting up filters, understanding project information, and bidders lists, this free, one-hour session is a great introduction to our Online Plan Room. There will be time at the end for questions and answers. [Register Here](#)

### **\*\* March 27 - Q1 Construction Economic Update & Forecast**

Crafted with commercial contractors in mind, Anirban Basu's presentation will offer up-to-the-minute economic data, including the cost of labor and materials, top market sectors and regions, and the Fed's ongoing efforts to engineer a soft landing for a tumultuous economy. Basu will also provide his thoughts as to if, and, or when we'll actually see a recession and how that may affect construction. [Sign Up Here](#)

### **April 2 - POWER Workshop #1: Making It In a Male-Dominated World**

Join POWER and workshop leader Nicole Middendorf for an open discussion on diversity and inclusion, and how we can bring more women into male-dominated careers. The number of women in these male-dominated industries, like construction, engineering, and finances, is barely gaining traction. Nicole herself never planned on being in a male-dominated industry, and Nicole wants to accelerate that change of seeing more women in these spaces. [Register Here](#)

### **April 17 - MBEX Spring Social**

Join us at TPC Golf Club in Blaine, Minn. with fellow construction business owners, executives, and industry professionals that includes a special guest speaker, drinks and delicious food, cash raffles benefiting the MBEX Construction Scholarship fund, and more. [Register Here](#)

### **April 18 - MBEX Online Plan Room Demo**

From navigating the Deskpads, setting up filters, understanding project information, and bidders lists, this free, one-hour session is a great introduction to our Online Plan Room. There will be time at the end for questions and answers. *Not yet open for registration*

### **\*\* Save the Date - June 5 - MBEX Member Appreciation BBQ**

Let MBEX treat you to lunch as a thank you for your continued membership and support! Join us for a casual afternoon of Famous Dave's barbecue, cold beverages, a handful of door prizes, and great company and networking. Each member company receives 2 complimentary tickets.

[View Full 2024 MBEX Event Calendar](#)



**CRAWFORD DOOR SALES COMPANY**

PH: (651) 455-1221 FAX: (651) 455-9559 [www.cdsdoor.com](http://www.cdsdoor.com)

RESIDENTIAL - COMMERCIAL - INDUSTRIAL



# CONSTRUCTION HEADLINES

## **CODES + STANDARDS**

### \* [ASHRAE Commercial Building Code Standard Now Requires On-Site Renewables](#)

The U.S. Department of Energy has issued ASHRAE a determination affirming that ANSI / ASHRAE / IES Standard 90.1-2022, which incorporates a renewable energy mandate for the first time, will improve energy efficiency in commercial buildings governed by the code. Within two years of the DOE's affirmative determination, states must certify that they have reviewed their commercial building code energy efficiency provisions and update those codes, if necessary, to meet or exceed the updated standard, ASHRAE said in a March 5th news release. (*Smart Cities Dive*)

## **ECONOMIC REPORTS**

### □ [Dodge Momentum Index Recedes 1% in February](#)

The Dodge Momentum Index (DMI) fell 1.4% in February to 180.5 from the revised January reading of 183.0. Over the month, commercial planning fell 2.3% and institutional planning ticked up 0.1%. Weaker office and healthcare planning constrained nonresidential planning in February, but the Index remains 25% higher than where it was just two years ago. (*Dodge Construction Network*)

## **WOMEN IN CONSTRUCTION**

### □♀ [Women in Construction Data Report Released](#)

In celebration and recognition of Women in Construction Week earlier this month, Lumber conducted a "She Builds Nation" survey and recently released its data. The results show a need for change within the industry. Women in construction are breaking down stereotypes and some are even rising through the ranks, but there is still a long way to go before women can be equally as safe and comfortable on the job site as their male counterparts. Only 10% of women comprise the construction workforce, with 4% working onsite. (*For Construction Pros*)

## **ROOFING SYSTEMS**

### □ [Technical Brief Addresses the Impact of Construction-Generated Moisture on Commercial Roofing Systems](#)

Construction-generated moisture comes from activities including pouring concrete, burning propane heaters, painting, plastering, and drywall finishing. To control moisture, designers must identify the sources of moisture and develop a remediation plan during the design process. To reduce the probability of condensation, buildings under construction must be adequately ventilated, particularly during concrete hydration and other high moisture-related construction activities. (*Building Design + Construction*)

## **RISK MANAGEMENT**

### □ [Surety Trends to Keep an Eye On in the Construction Industry](#)

Due to increased spending, many contractors are reporting historically high backlogs --- and that often includes the largest project their company has contracted in their history. While increased spending presents more opportunity, it's critical contractors be even more diligent about new opportunities, giving additional consideration to job selection, margins, contract terms, and new entrants. As surety companies and their reinsurers respond to project losses, it's essential for contractors to align themselves with an experienced surety broker who can navigate today's evolving market conditions and industry shifts. (*Construction Executive*)

PROJECT OF THE WEEK  
**Mortenson to Build \$800M Meta Data Center**

Golden Valley-based Mortenson has been tapped to build the 715,000-square-foot project on a 280-acre site at UMore Park in Rosemount, a former WWII gunpowder production site that was later owned by the University of Minnesota. The project promises to put more than 1,000 hardhats to work and create roughly 100 operational jobs. The campus will be powered with 100% renewable energy. When it begins operations in 2026, the data center will achieve LEED Gold Certification, according to the Minnesota Department of Employment and Economic Development (DEED). *(Finance & Commerce)*

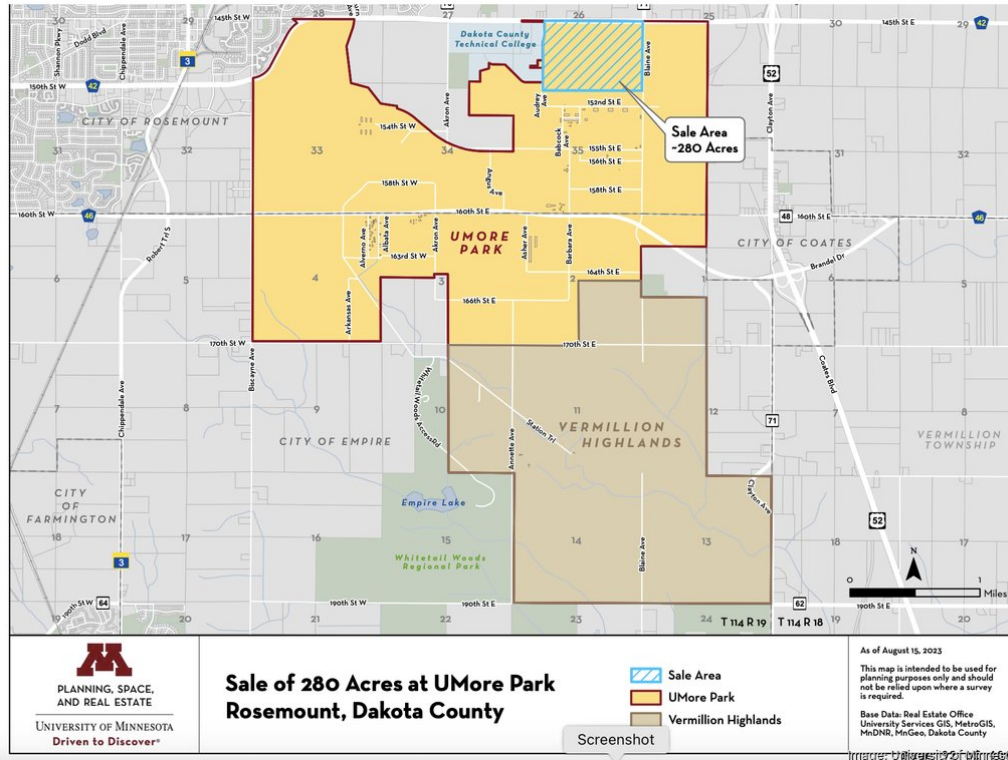

A map of the UMore Park property, including a shaded area where Meta Platforms, Inc. plans a \$800-million data center. (Graphic: [Minneapolis / St Paul Business Journal](#))

## INDUSTRY EVENTS



**Winning MnDOT Work - 302 Successful Submittals**  
Presented by DBE Business Academy

**DATE:** Tuesday, March 26

**TIME:** 8:30am - 12:30pm

**LOCATION:** Attend Online - link

[Register Here](#)



provided when you register

**COST:** Free

Gain an understanding of the components of a successful bid and review the submittal process.

This advanced-level class includes presentations from prime contractors. Learn from their experience and what they look for from their subcontractors.

Questions: [sbaker@imoconsultinggroup.com](mailto:sbaker@imoconsultinggroup.com)

---

## **Working with Unions: What Contractors Should Know** **Presented by North Central States Regional Council of Carpenters**

**DATE:** Wednesday, March 27

**TIME:** 1:30pm - 2:30pm

**LOCATION:** North Central States  
Regional Council of Carpenters (730 Olive  
St., St Paul, MN 55130)

[Register Here](#)

**COST:** Free

Many contractors have considered partnering with unions, but aren't sure what that would entail for their business. Other contractors have already signed a union contract, but would like more insight on how to manage that relationship and what it means.

In this session, attendees will hear from a labor lawyer who represents contractor interest, a union representative, and an administrator of the union fringe benefit funds. They will review union structures and related terminology, tips for paying union fringe funds, and best practices for working with unions.

They will also answer questions and concerns that the audience may have about being or becoming a union contractor.

---

## **DOT Hazardous Material & Hazardous Waste Management Training Seminar | Presented by Safety-Kleen**

**DATE:** Thursday, March 28

**TIME:** HazMat Training: 8:00am-  
11:15am | RCRA Training: 11:30am-  
12:30pm

**LOCATION:** Online

**COST:** \$400 / person

[Register Here](#)

Join Safety-Kleen for their offered DOT / RCRA Compliance Training: DOT Hazardous Materials (HazMat) and Hazardous Waste Management (RCRA).

### **HazMat Training**

This seminar will teach employees the proper prepping, packaging, placarding, and labeling required to ship Hazardous Materials. Every employee involved in shipping, transporting, or handling hazardous materials must receive training to be certified; the training must be repeated at least every 36 months; and the training must be updated whenever there is a regulation change affecting an employee's job duties.

### RCRA Training

This seminar will teach employees how to identify hazardous waste, proper waste management of hazardous waste and universal waste, how to complete manifests accurately, emergency preparedness and release reporting.

For additional information on the seminar program or to enroll, please contact Michael Fisher: [\(612\) 283-7007](tel:6122837007) or [michael.fisher@safety-kleen.com](mailto:michael.fisher@safety-kleen.com). You can also [download this flyer](#).



**HERE FOR YOU & YOUR BUSINESS BANKING NEEDS**

Mike Demuth | 218-316-3535 | [mike.demuth@deerwoodbank.com](mailto:mike.demuth@deerwoodbank.com)

**DEERWOOD BANK**  
*Since 1856*

## MEMBER BENEFITS



### Benefits of the Week: Springtime Deals with NPP

Even if the weather disagrees, the calendar says spring is officially here and it's time to leap into savings with National Purchasing Partners.

Save on products your business regularly uses by first [becoming an NPP member](#) (it's free!), then take advantage of the following limited-time offers:

Save 35% off select accessories through Verizon. [Learn more](#)



Activate members-only savings with Sherwin-Williams to take advantage of ProBlock Gray Primer.



**SHERWIN-WILLIAMS.**

[NPP Price: \\$6.09](#)

Activate savings with ODP Business Solutions on Copy Paper 20lbs / 10RM.



[NPP Price: \\$39.99](#)

Save up to 65% off [Cintas services](#), including facility services, uniform rental services, first aid and safety kits, as well as disinfectant and sanitizer services.



Take advantage of limited time savings on WorkHog Work Boots through Ariat Crew.



[NPP Price: \\$155.96](#)

Save up to 50% off HVAC air filter products with [Tri-Dim](#).



-----  
NPP (National Purchasing Partners) is a member benefit provider of the Minnesota Builders Exchange (MBEX), offering savings on products and services that businesses and employees use every day.

Start saving by enrolling your business with NPP for free to activate this offer (and others like it) here: <https://mynpp.com/association/mbex/>. Restrictions many apply.

**MARBLE LOBBY LEGAL COUNSEL  
WITHOUT ALL THE MARBLE.**  
Call 952.835.1614 or visit [droellaw.com](http://droellaw.com)

## PROJECT INFORMATION + UPDATES

- Total Projects Received at MBEX from 3/11/2024 - 3/15/2024: **100**
- Total Projects Leads Reported on at MBEX from 3/11/2024 - 3/15/2024: **4**
- Total Active Projects Received/Reported on at MBEX as of 3/19/2024: **380**
- Total Projects in the Online Plan Room as of 3/19/2024: **1,150**

[DOWNLOAD HERE](#)

Click the button above to view the most recent project data from 3/13/2024-3/19/2024.

For information about the *Bulletin's* content, technical issues, or to place an ad (such as a Minority Notice, Job Posting, or Event Notice), contact [Ashlee](#), Membership + Communications Manager.



The MBEX *Weekly Bulletin* brought to you in part by [The Builders Group \(TBG\)](#).

---

## UPCOMING MBEX EVENTS

- [March 20 & 21](#) - Reading Construction Documents online course with UChapter2
- [March 21](#) - Online Plan Room Demo
- [March 27](#) - 2024 Q1 Construction Economic Update & Forecast
- [March 28](#) - DOT Hazardous Material & Hazardous Waste Management Training Seminar
- [April 2](#) - POWER Workshop #1 - Making It in a Male-Dominated World
- [April 17](#) - MBEX Spring Social
- [April 18](#) - Online Plan Room Demo

Connect with the Builders Exchange:



Revisit Past Bulletins:

[March 13 - No. 11](#) | [March 6 - No. 10](#) | [February 28 - No. 9](#) | [February 21 - No. 8](#)

---

Information within the MBEX *Weekly Bulletin* are obtained from sources deemed reliable. The Minnesota Builders Exchange (MBEX) does not assume responsibility for its completeness or accuracy. You are urged to check your own sources in addition to the information contained in this publication. This issue contains plans and other bidding information received prior to and including the date noted above. The project data within this newsletter is intended for member company's and their employees use only.

**2024 BOARD OFFICERS:** President - Mike Carlson, *Max Gray Construction*; Vice President - Heidi Sedlacek, *Bituminous Roadways*; Treasurer - Brian Kalla, *St. Cloud Acoustics*; Past President - Greg Grazzini, *Grazzini Brothers* | **2024 DIRECTORS:** Allie Brady, *Veit*; Kevin Bohrer, *Donlar Construction*; David Brandt, *Schadegg Mechanical*; Jason DuVal, *Tenet*; Chuck Geisler, *American Engineering Testing*; Chris Niemand, *Frattalone Companies*; Sean Ochis, *Northern Industrial Insulation*; Jason Rentmeester, *Kraus-Anderson Construction*; and Nate Sapik, *Benson Electric Company* | **STAFF:** David Siegel - *Executive Director*; Julie Miller - *Executive Assistant/Project Coordinator/Accounting*; Jeff Boelter - *Project Acquisition & IT*; Ashlee Hartwig - *Membership & Communications Manager*; Don O'Connor - *Duluth Branch Manager*; Shauna Baska, Peggy Esboldt, Janet Margheim, Michelle Siegel & Ka Yang - *Project Reporters*

You are receiving this email because you are employed by a current member company in good standing or have indicated you wanted to receive MBEX's *Weekly Bulletin*. [Unsubscribe from the Weekly Bulletin](#)

[Member Directory](#)

[Contact Us](#)

[Blueprint magazine](#)

Minnesota Builders Exchange | 1123 Glenwood Avenue, Minneapolis, MN 55405

[Unsubscribe ah@mbex.org](mailto:ah@mbex.org)

[Update Profile](#) | [Our Privacy Policy](#) | [Constant Contact Data Notice](#)

Sent byah@mbex.orgpowered by



Try email marketing for free today!